

**SITE DATA**

**PROJECT DESCRIPTION:** THE INSTALLATION OF A PROPOSED ANTENNAS ON A PROPOSED 150' MONOPOLE TOWER AND CONCRETE PAD INSIDE A PROPOSED FENCED COMPOUND

**LOCATION:** STATE OF OHIO, COUNTY OF FRANKLIN, CITY OF GROVE CITY

**SITE ADDRESS:** 3363 McDOWELL RD. GROVE CITY, OH 43123

**SITE COORDINATES:** LATITUDE: 39° 52' 46.90" N (NAD 83)  
LONGITUDE: 83° 3' 40.13" W (NAD 83)  
GROUND ELEVATION: 788.3 FT (NAD 88)

**PROPERTY OWNER:** PASCHALL POST 164 AMERICAN LEGION INC

**TAX PARCEL:** 040005964

**APPLICANT:** CAPITAL TELECOM HOLDINGS II LLC  
1500 MT. KEMBLE AVE. SUITE 203  
MORRISTOWN, NJ 07960

**CO-APPLICANT:** NEW PAR d/b/a VERIZON WIRELESS  
7575 COMMERCE COURT  
LEWIS CENTER, OH 43035

**DRIVING DIRECTIONS:**  
FROM THE LEWIS CENTER OFFICE, TRAVEL SOUTH ON US-23 S. MERGE ONTO I-270 W VIA EXIT 23B TOWARD INDIANAPOLIS. TAKE SOUTH FWY S TOWARD CINCINNATI. TAKE THE STRINGTOWN RD EXIT, EXIT 100 TOWARD GROVE CITY. TURN RIGHT ONTO STRINGTOWN RD. TURN RIGHT ONTO McDOWELL RD.

**NON-RESIDENTIAL DISTRICT REQUIREMENTS**

	TOWER		EQUIPMENT STRUCTURE	
	SETBACK REQUIREMENT	ACTUAL	SETBACK REQUIREMENT	ACTUAL
	TWICE THE HEIGHT OF TOWER (300') (FROM RESIDENTIAL STRUCTURE)	<300'	N/A	N/A
FRONT YARD	100% OF TOWER HEIGHT (150')	371.88'	30'	362.01'
SIDE YARD	100% OF TOWER HEIGHT (150')	(EAST) = 55.7' (WEST) = 265.83'	30'	(EAST) = 37.81' (WEST) = 270.73'
REAR YARD	100% OF TOWER HEIGHT (150')	121.08'	30'	110.44'

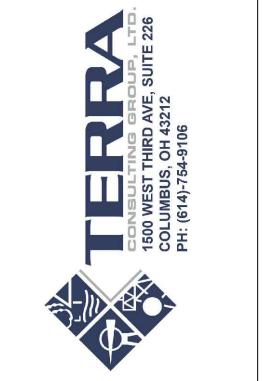
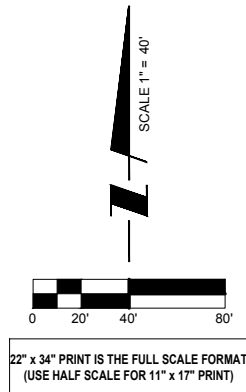

**LOCATION MAP**

N.T.S.

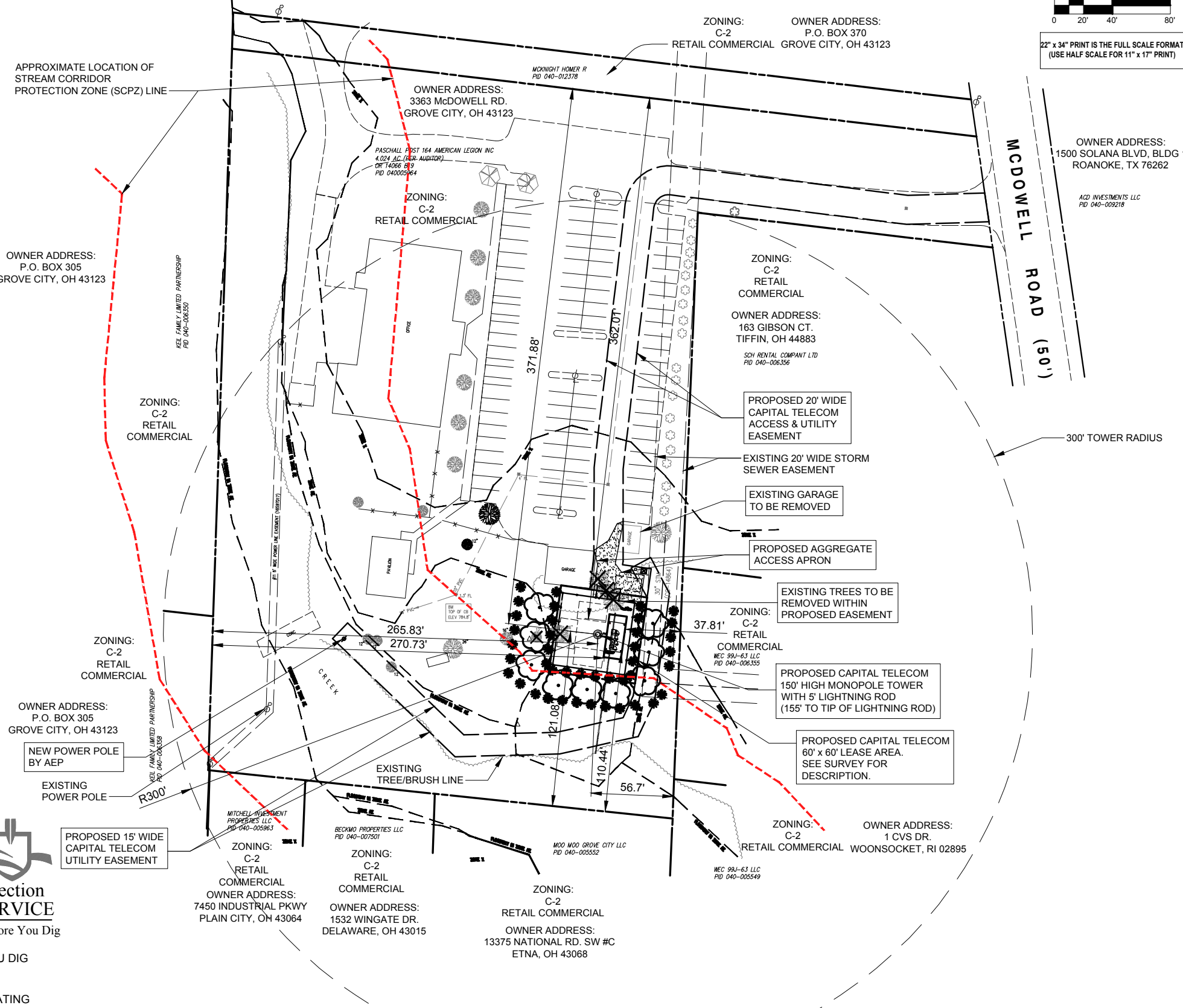
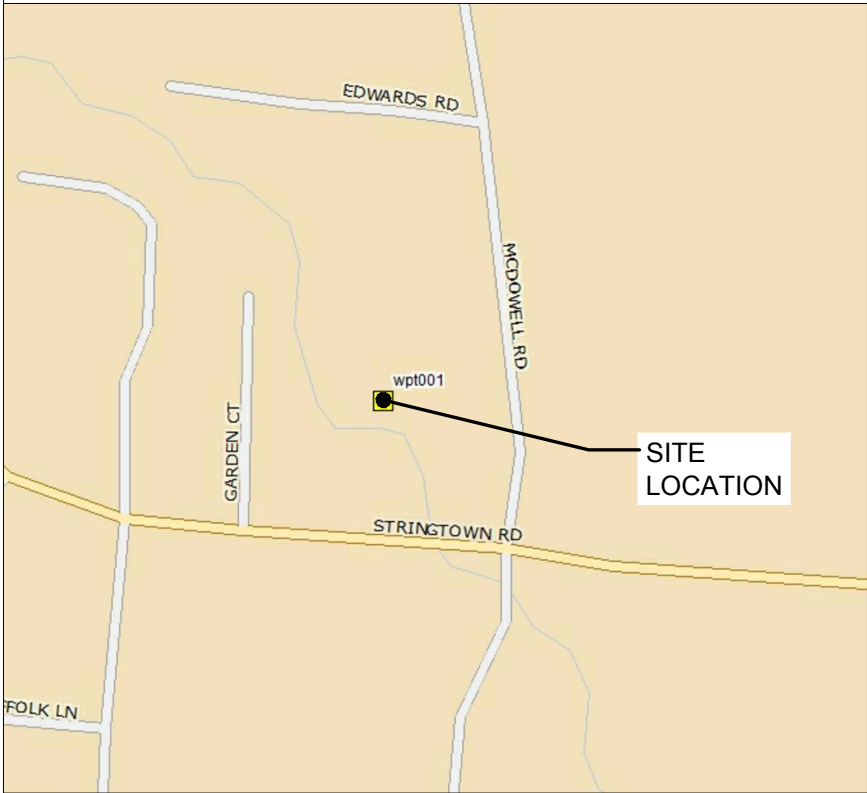

**LANDLORD APPROVAL**

SIGNATURE: \_\_\_\_\_

PRINT NAME: \_\_\_\_\_

TITLE: \_\_\_\_\_

DATE: \_\_\_\_\_



CALL BEFORE YOU DIG  
1-800-362-2764 AT  
LEAST 48 HOURS  
PRIOR TO EXCAVATING

**REVISIONS**

NO.	DESCRIPTION	DATE	BY
A	ISSUED FOR REVIEW	6/14/17	JAY
B	CLIENT COMMENTS	7/10/17	JAY
C	ADD LP TANK	12/6/17	JAY
D	REMOVE GENERATOR & LP TANK	12/12/17	JAY
E	CLIENT COMMENTS	1/15/18	JAY
F	ADDITIONAL LANDSCAPING	1/19/18	JAY
G	RELOCATE LEASE AREA	2/26/18	JAY

**CLMB-397  
STRINGTOWN RD**

3363 McDOWELL RD.  
GROVE CITY, OH 43123

DRAWN BY: JAY

CHECKED BY: JS

DATE: 6/14/17

PROJECT #: 84-039

SHEET TITLE  
**LOCATION PLAN  
SITE DATA &  
LOCATION MAP**

SHEET NUMBER  
**Z-1**

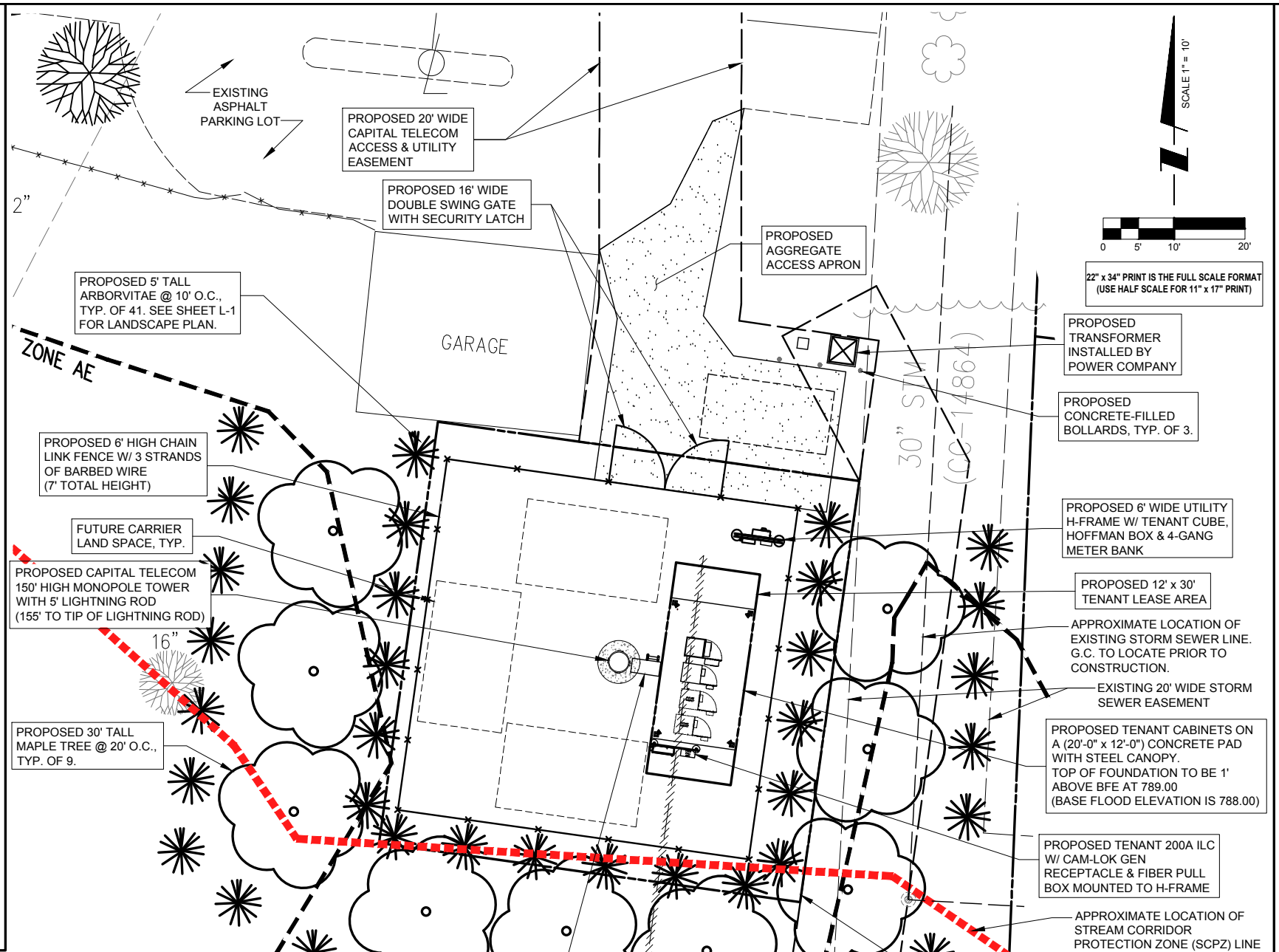
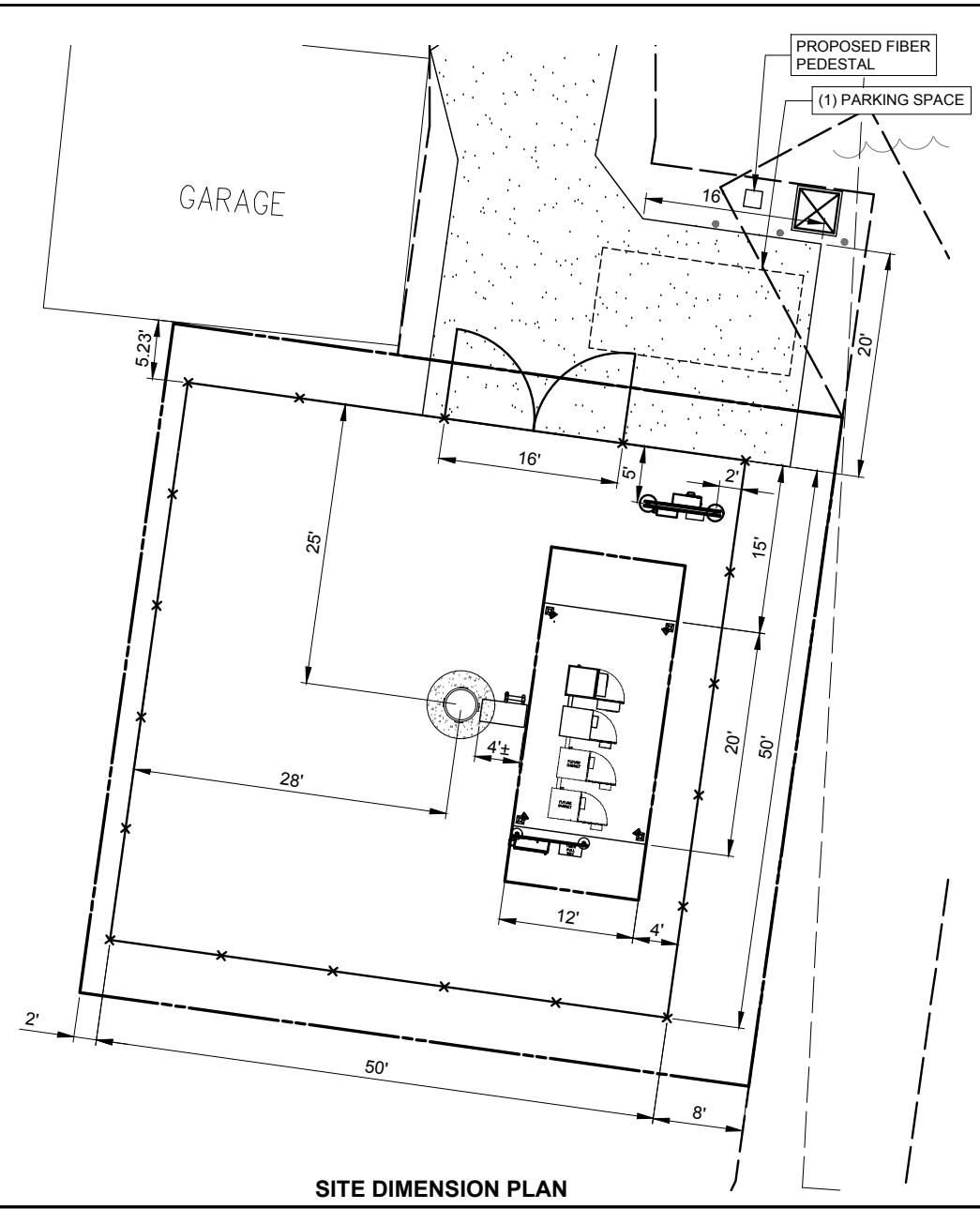
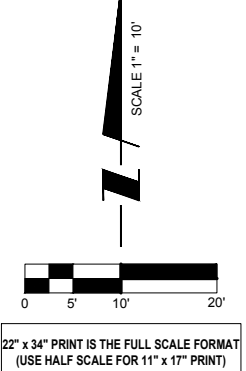

SURVEY PREPARED BY  
*PS SURVEYING & MAPPING GROUP, LLC*  
1425 PENTLAND PLACE  
COLUMBUS, OH 43235  
OFFICE: (614) 531-1122

**GRAVEL MATERIAL**  
ACCESS ROAD (HATCHED)  
208 S.Y.  
4" NO.2, 4" OF NO. 304 AGGREGATE BASE,  
2" NO.57 LIMESTONE FINISHED SURFACE

LEASE SITE  
400 S.Y.  
4" NO.2, 4" OF NO. 304 AGGREGATE BASE,  
2" NO.57 LIMESTONE FINISHED SURFACE

THE CONTRACTOR SHALL INCLUDE AS PART OF THE BID, THE COST OF REMOVAL OF ANY SURFACE VEGETATION AND ORGANIC SOILS OR OTHER DELETERIOUS MATERIALS AND THE REPLACEMENT WITH ENGINEERED BACKFILL FOR THE AGGREGATE ACCESS DRIVE AND LEASE SITE, IN ACCORDANCE WITH THE RECOMMENDATIONS OF THE GEOTECHNICAL REPORT.



CALL BEFORE YOU DIG  
1-800-362-2764 AT  
LEAST 48 HOURS  
PRIOR TO EXCAVATING

CONTRACTOR IS RESPONSIBLE FOR ANY DAMAGE TO EXISTING PAVEMENT. CONTRACTOR SHALL PHOTOGRAPH AND VIDEOTAPE EXISTING PAVEMENT PRIOR TO CONSTRUCTION. ANY DAMAGE CAUSED DURING CONSTRUCTION SHALL BE REPLACED TO EXISTING OR BETTER CONDITION AT NO ADDITIONAL COST.

THE CONTRACTOR WILL, UPON BECOMING AWARE OF SUBSURFACE OR LATENT PHYSICAL CONDITIONS DIFFERING FROM THOSE DISCLOSED BY THE ORIGINAL SOIL INVESTIGATION WORK, PROMPTLY NOTIFY THE OWNER VERBALLY AND IN WRITING, AS TO THE NATURE OF THE DIFFERING CONDITIONS. NO CLAIM BY THE CONTRACTOR FOR ANY CONDITIONS DIFFERING FROM THOSE ANTICIPATED IN THE PLANS AND SPECIFICATIONS AND DISCLOSED BY THE SOIL STUDIES WILL BE ALLOWED UNLESS THE CONTRACTOR HAS SO NOTIFIED THE OWNER, VERBALLY AND IN WRITING, AS REQUIRED ABOVE, OF SUCH DIFFERING SUBSURFACE CONDITIONS.

BEFORE AND DURING CONSTRUCTION, THE CONTRACTOR SHALL PROVIDE ADEQUATE EROSION CONTROL AS NECESSARY IN THE FORM OF SILT FENCES FOR THE SITE AND BALES AROUND ANY EXISTING MANHOLES, INLETS, OR CATCHBASINS SUSCEPTIBLE TO EROSION. EROSION CONTROL MEASURES SHALL BE PERIODICALLY INSPECTED TO ENSURE PROPER FUNCTION. EROSION CONTROL SHALL BE REMOVED UPON COMPLETION OF WORK.

CONTRACTOR TO PROVIDE APPROXIMATE 50'x50' STAGING AREA AND TEMPORARY ROAD. CONTRACTOR SHALL COORDINATE WITH ANTENNA CONTRACTOR, A STAGING AREA AND TEMPORARY ROAD THAT IS ACCEPTABLE TO THE OWNER. STAGING AREA AND TEMPORARY ROAD SHALL BE RESTORED TO EXISTING CONDITIONS AS NECESSARY UPON COMPLETION OF THE PROJECT.

REVISIONS

NO.	DESCRIPTION	DATE	BY
A	ISSUED FOR REVIEW	6/14/17	JAY
B	CLIENT COMMENTS	7/10/17	JAY
C	ADD LP TANK	12/6/17	JAY
D	REMOVE GENERATOR & LP TANK	12/12/17	JAY
E	CLIENT COMMENTS	1/15/18	JAY
F	ADDITIONAL LANDSCAPING	1/19/18	JAY
G	RELOCATE LEASE AREA	2/26/18	JAY

**CLMB-397**  
**STRINGTOWN RD**

3363 McDOWELL RD.  
GROVE CITY, OH 43123

DRAWN BY: JAY  
CHECKED BY: JS  
DATE: 6/14/17  
PROJECT #: 84-039

SHEET TITLE  
**ENLARGED SITE PLAN**

SHEET NUMBER  
**Z-2**

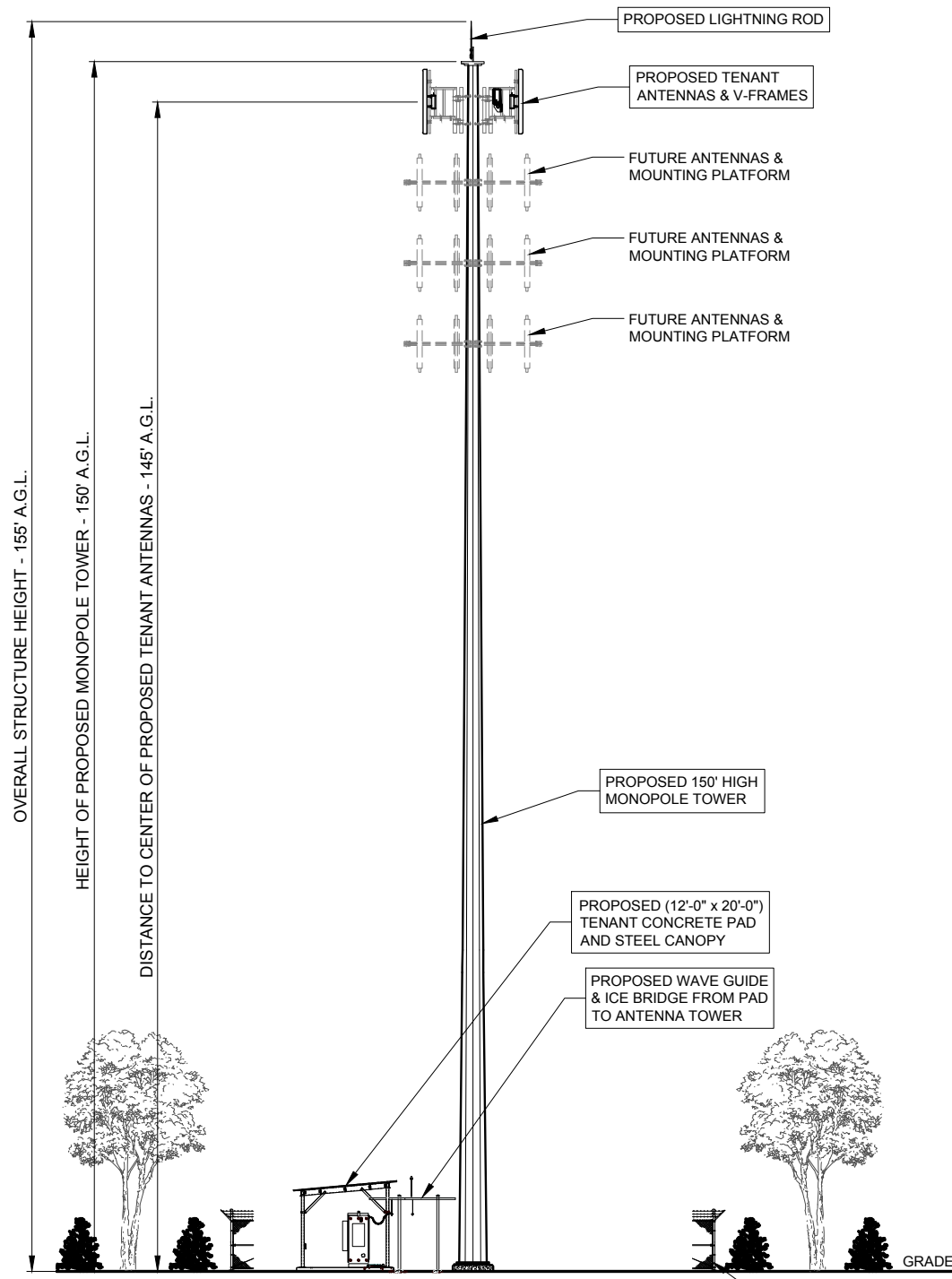

**1 SITE ELEVATION**  
SCALE: 3/32" = 1'-0"

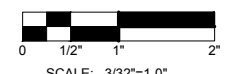

22" x 34" PRINT IS THE FULL SCALE FORMAT  
(USE HALF SCALE FOR 11" x 17" PRINT)

**TOWER NOTES:**

1. THE PROPOSED ANTENNA MOUNTS, AND ANTENNAS TO BE DESIGNED BY OTHERS.
2. THE PROPOSED ANTENNA MOUNTS SHALL MEET ALL REQUIREMENTS LISTED IN THE VERIZON WIRELESS STATEMENT OF WORK, SECTION 6.5.2.
3. THE HYBRID CABLES, OVP'S, & RRR'S SHALL BE INSTALLED PER THE GUIDELINES LISTED IN THE VERIZON WIRELESS STATEMENT OF WORK, SECTIONS 6.5.3 - 6.5.6.
4. THE TOWER ELEVATION SHOWN IS FOR REFERENCE ONLY.
5. SEE STRUCTURAL ANALYSIS FOR FINAL HYBRID CABLE / COAX ROUTING.
6. CONTRACTOR TO REQUEST RF WORK ORDER AND CONFIRM ALL ORIENTATION, AZIMUTH AND DOWNTILT SITE SPECIFIC DESIGNS PRIOR TO TOWER CREW ARRIVAL ON SITE.

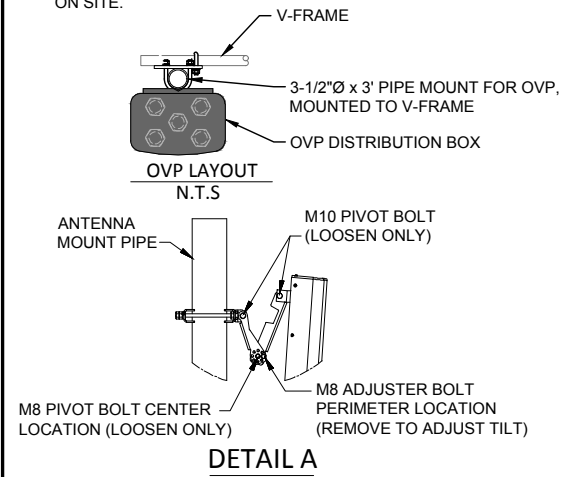

**DETAIL A**

NOTE:  
ANTENNA MOUNTS, ORIENTATION AND TOWER PROFILE ARE DIAGRAMMATIC ONLY. ANTENNA SUPPORT PER STRUCTURE MANUFACTURER AND STRUCTURAL ANALYSIS.

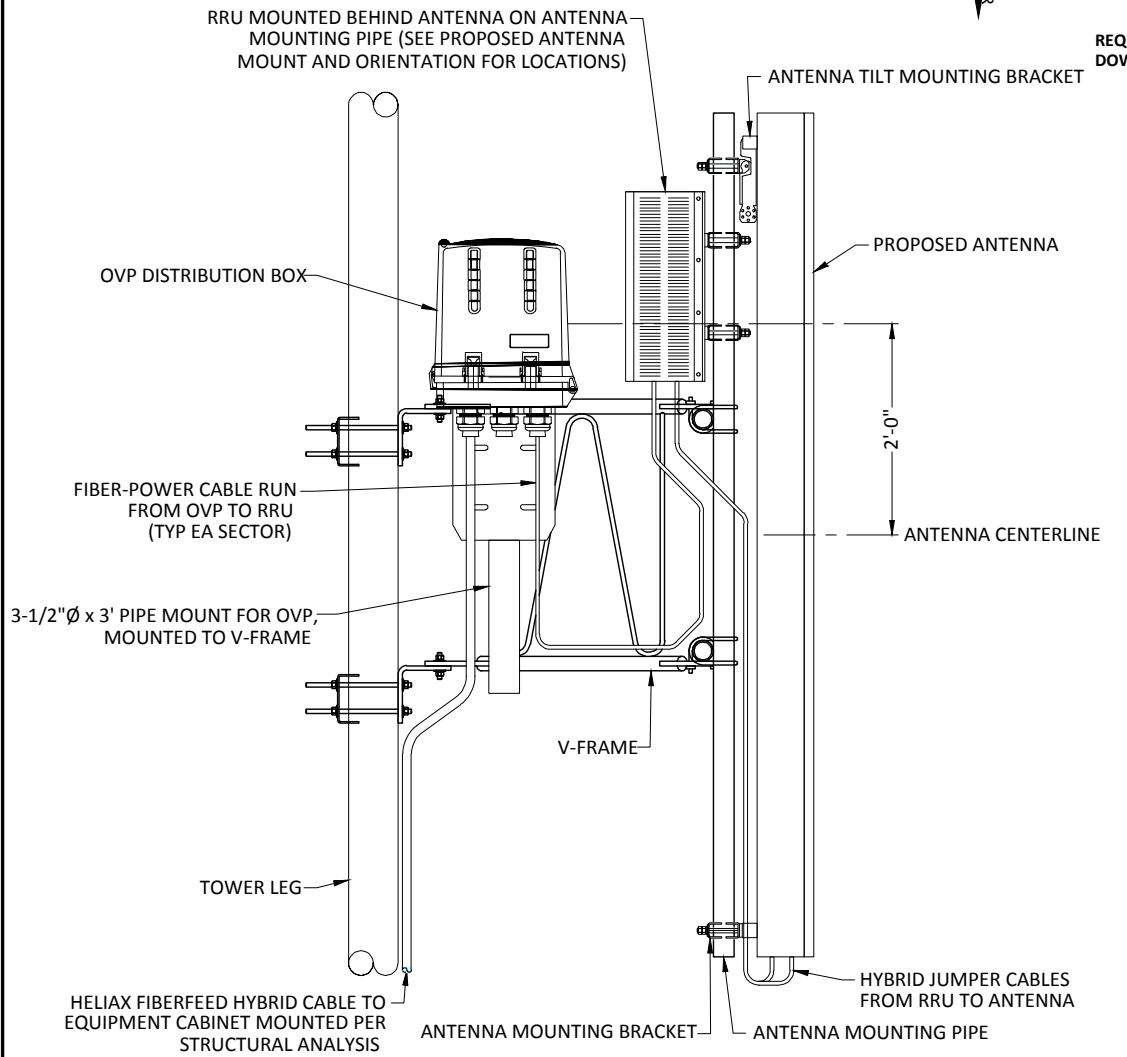

**3 OVP/RRU/ANTENNA DETAIL**  
N.T.S.

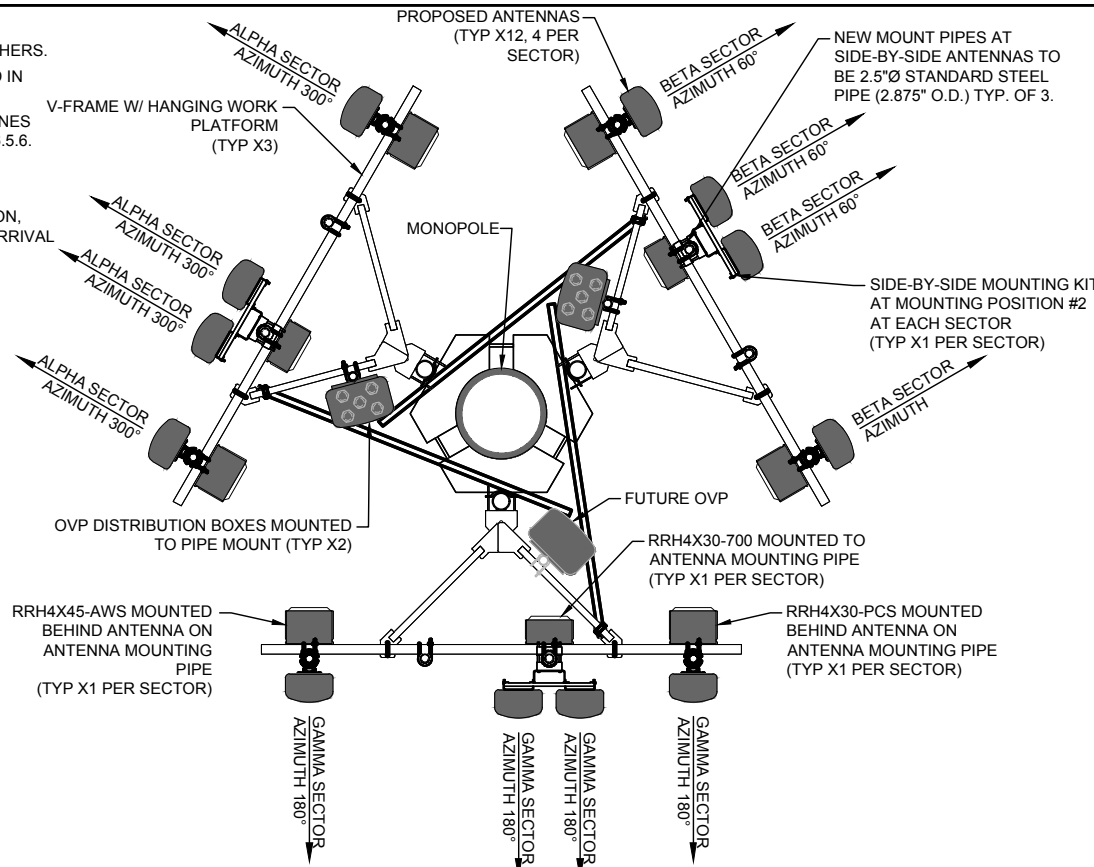

REQUEST RF WORK ORDER AND CONFIRM ALL ORIENTATION, AZIMUTH AND DOWNTILT SITE SPECIFIC DESIGNS PRIOR TO TOWER CREW ARRIVAL ON SITE

**2 PROPOSED ANTENNA PLAN**  
N.T.S.

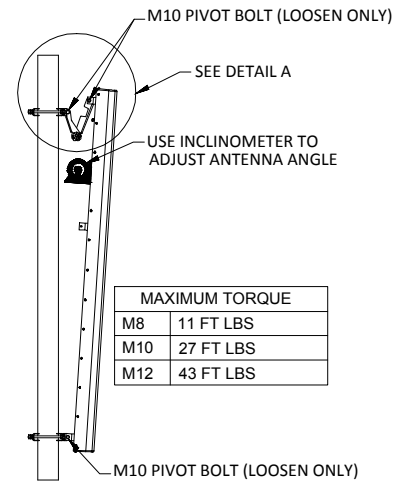

MAXIMUM TORQUE	
M8	11 FT LBS
M10	27 FT LBS
M12	43 FT LBS

1. LOOSEN PIVOT BOLTS. (DO NOT REMOVE)
2. REMOVE ADJUSTER BOLTS.
3. ADJUST ANTENNA ANGLE. (USE INCLINOMETER)
4. REINSTALL ADJUSTER BOLTS
5. RETIGHTEN ALL BOLTS.
6. DO NOT TIGHTEN BOLTS ABOVE MAXIMUM TORQUE.

**4 ANTENNA TILT ADJUSTMENT**  
N.T.S.

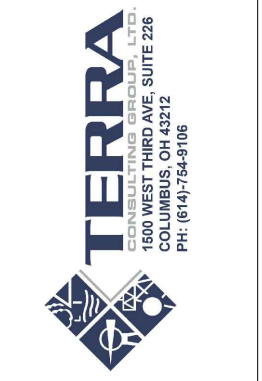

NO.	DESCRIPTION	BY	DATE
A	ISSUED FOR REVIEW	JAY	6/14/17
B	CLIENT COMMENTS	JAY	7/10/17
C	ADD LP TANK	JAY	12/6/17
D	REMOVE GENERATOR & LP TANK	JAY	12/12/17
E	CLIENT COMMENTS	JAY	1/15/18
F	ADDITIONAL LANDSCAPING	JAY	1/19/18
G	RELOCATE LEASE AREA	JAY	2/26/18

**CLMB-397**  
**STRINGTOWN RD**

3363 McDOWELL RD.  
GROVE CITY, OH 43123

DRAWN BY:	JAY
CHECKED BY:	JS
DATE:	6/14/17
PROJECT #:	84-039

SHEET TITLE  
**SITE ELEVATION & ANTENNA DETAILS**

SHEET NUMBER  
**ANT-1**

# GENERAL LANDSCAPE NOTES

1. PRUNE NEWLY INSTALLED SHRUBS. WORK SHALL BE DONE BY EXPERIENCED PERSONNEL TO THE ACCEPTED HORTICULTURAL AND ARBORICULTURAL STANDARDS. PRUNING SHALL RESULT IN A LOOSE OUTLINE CONFORMING TO THE GENERAL SHAPE OF THE SHRUB TYPE. DO NOT USE HEDGE SHEARS.
2. ALL PLANTING STOCK SHALL BE NURSERY-GROWN IN ACCORDANCE WITH GOOD HORTICULTURAL PRACTICE. PLANTS SHALL BE FREE OF DISEASE, INSECTS EGGS, LARVAE AND DEFECTS SUCH AS KNOTS, SUN-SCALD, INJURIES, ABRASIONS OR DISFIGUREMENT. THEY SHALL HAVE SOUND, HEALTHY VIGOROUS AND UNIFORM GROWTH TYPICAL OF THE SPECIES AND VARIETY, WELL-FORMED, FREE FROM IRREGULARITIES, WITH THE MINIMUM QUALITY AND SIZE CONFORMING TO AMERICAN STANDARD FOR NURSERY STOCK.
3. GUARENTEE: WARRANT ALL PLANT MATERIAL TO BE TRUE TO BOTANICAL NAME AND SPECIFIED SIZE. AFTER COMPLETION OF PLANTING, ALL PLANT MATERIALS SHALL BE WARRANTED AGAINST DEFECTS, INCLUDING DEATH AND UNSATISFACTORY GROWTH FOR A WARRANTY PERIOD OF ONE YEAR. THE CONTRACTOR WILL NOT BE RESPONSIBLE FOR DEFECTS RESULTING FROM NEGLIGENCE, ABUSE, DAMAGE BY OTHERS, OR UNUSUAL PHENOMENA OR INCIDENTS BEYOND THE CONTRACTORS CONTROL WHICH RESULT FROM NATURAL CAUSES SUCH AS FLOODS STORMS, FIRES OR VANDALISM.  
REPLACEMENTS: DURING THE WARANTY PERIOD, REPLACE ONE TIME, AT NO ADDITIONAL COST TO THE OWNER, PLANT MATERIALS THAT ARE DEAD, OR IN THE OPINION OF THE LANDSCAPE ARCHITECT, IN AN UNHEALTHY OR UNSIGHTLY CONDITION. REJECTED PLANT MATERIALS SHALL BE REMOVED FROM THE SITE AT CONTRACTOR'S EXPENSE. REPLACEMENTS ARE TO BE MADE NO LATER THAN THE SUBSEQUENT PLANTING SEASON. RESTORE AREAS DISTURBED BY REPLACEMENT OPERATIONS.
4. MULCHING SHALL BE DONE WITHIN 48 HOURS AFTER PLANTING. MULCH SHRUB BEDS TO A UNIFORM DEPTH OF THREE INCHES. MULCH SHALL BE CLEAN COMPOSTED PINE BARK MULCH FREE OF FOREIGN MATERIAL AND LARGE PIECES OVER THREE INCHES LONG. DO NOT MULCH TREE AND SHRUB PLANTING PITS.
5. TOPSOIL SHALL CONSIST OF FERTILE FRIABLE NATURAL LOAM, CONTAINING A LIBERAL AMOUNT OF HUMUS AND SHALL BE SUBJECT TO INSPECTION AND APPROVAL. IT SHALL BE FREE OF ADMIXTURES OF SUBSOIL AND FREE OF CRAB GRASS, ROOTS, STICKS AND OTHER EXTRANEIOUS MATTER, AND SHALL NOT BE USED FOR PLANTING OPERATIONS WHILE IN A FROZEN OR MUDDY CONDITIONS.
6. REPAIR ALL TURF AREAS BY SEEDING. SEEDING INSTALLATION SHALL BE EXECUTED ONLY AFTER ALL FINISH GRADING HAS BEEN COMPLETED. NO SEEDING WORK SHALL BE DONE PAST SEPTEMBER 15, UNLESS APPROVED BY THE OWNER'S REPRESENTATIVE.  
SEED: SEED MIX SHALL MATCH EXISTING TURF, OR BE A 50/50 MIX OF CERTIFIED IMPROVED BLEND OF BLUEGRASS AND CERTIFIED IMPROVED PERENNIAL RYE. MIX SHALL BE APPROVED BY THE OWNER'S REPRESENTATIVE PRIOR TO PLANTING. SEEDING SHALL BE APPLIED AT A MINIMUM RATE OF 120 POUNDS PER ACRE. FUTERRA BLANKET, OR EQUAL, SHALL BE USED FOR EROSION CONTROL MULCH WHERE NECESSARY IN LIEU OF HYDRO MULCH.

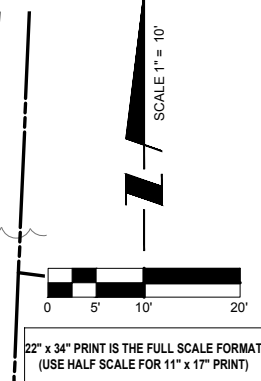
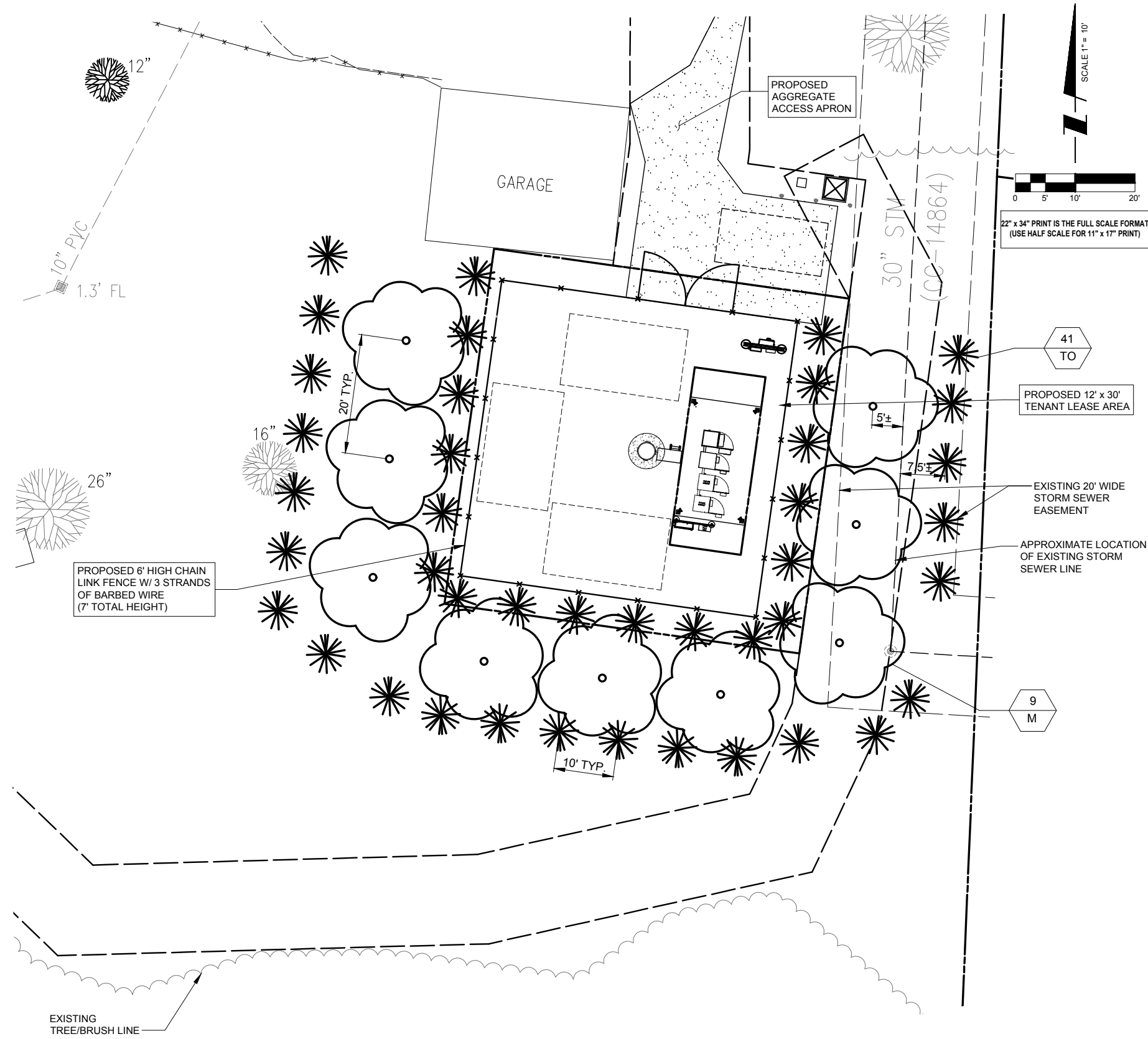

NOTE:  
CAPITAL TELECOM IS RESPONSIBLE FOR MAINTAINING THE LANDSCAPE AROUND THE COMPOUND.

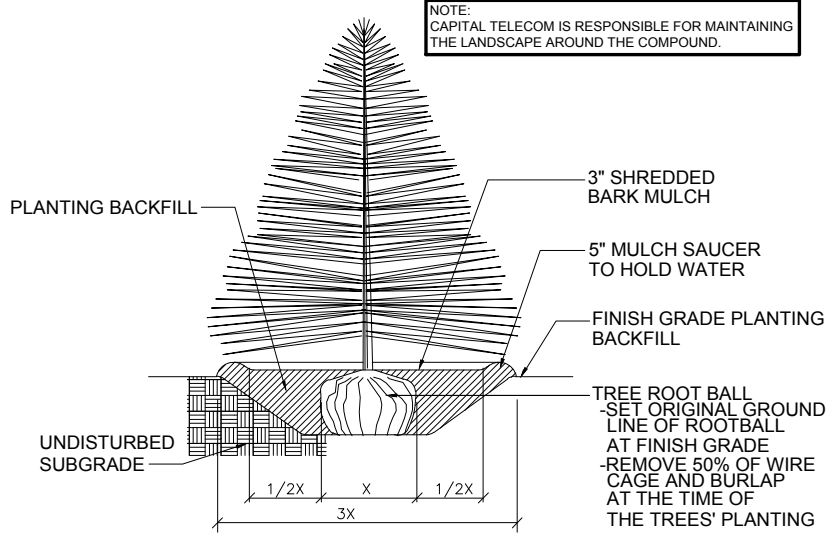

## 1 EVERGREEN TREE PLANTING N.T.S.

### PLANT LIST

SYMBOL	BOTANICAL NAME	COMMON NAME	QUANTITY	CALIPER	HEIGHT AT PLANTING	HEIGHT AT MATURITY	COMMENTS
TREES							
TO	THUJA OCCIDENTALIS	AMERICAN ARBORVITAE	42	2"	6 FT. HT. MIN.	10-15 FT. HT.	B & B (BALLED & BURLAPPED)
M	ACER	MAPLE	9	2"	15 FT. HT.±	30 FT. HT.	B & B (BALLED & BURLAPPED)

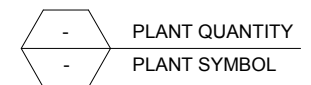

\* PER INDUSTRY STANDARD, ARBORVITAE AND OTHER EVERGREENS ARE NOT SIZED BY CALIPER BUT BY HEIGHT. A 6' ARBORVITAE HAS A (ESTIMATED) 2" CALIPER.

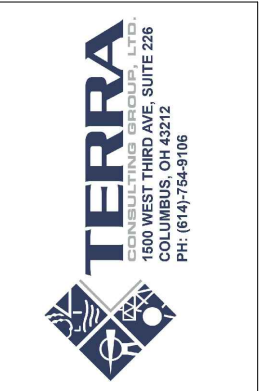

NO.	DESCRIPTION	DATE	BY
A	ISSUED FOR REVIEW	6/14/17	JAY
B	CLIENT COMMENTS	7/10/17	JAY
C	ADD LP TANK	12/6/17	JAY
D	REMOVE GENERATOR & LP TANK	12/12/17	JAY
E	CLIENT COMMENTS	1/15/18	JAY
F	ADDITIONAL LANDSCAPING	1/19/18	JAY
G	RELOCATE LEASE AREA	2/26/18	JAY

## CLMB-397 STRINGTOWN RD

3363 McDOWELL RD.  
GROVE CITY, OH 43123

DRAWN BY:	JAY
CHECKED BY:	JS
DATE:	6/14/17
PROJECT #:	84-039

### SHEET TITLE LANDSCAPE PLAN

### SHEET NUMBER L-1