

SEE MAP INDEX 39049CIND1C (SHEET 1 OF 4)

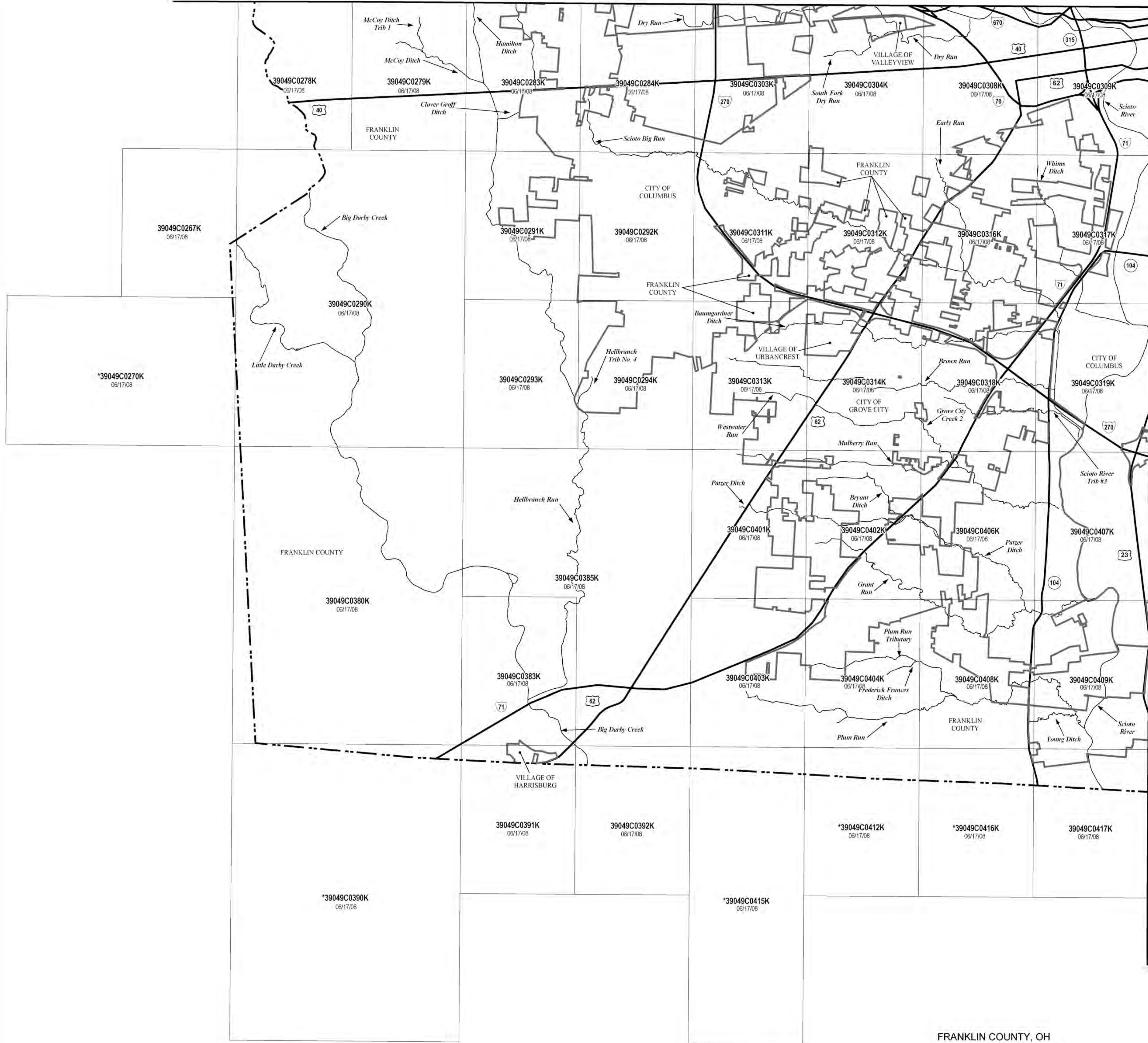

SEE MAP INDEX 39049CIND4C (SHEET 4 OF 4)

LISTING OF COMMUNITIES

COMMUNITY NAME	COMMUNITY NUMBER	LOCATED ON PANEL(S)	INITIAL NFIP MAP DATE	INITIAL FIRM DATE	MOST RECENT FIRM PANEL DATE
BEXLEY, CITY OF	390168	0327, 0329, 0331, 0333	May 17, 1974	November 15, 1978	June 17, 2008
BRICE, VILLAGE OF	390898	0362	August 2, 1995	August 2, 1995	June 17, 2008
CANAL WINCHESTER, VILLAGE OF	390169	0451, 0452, 0453, 0454, 0456, 0458, 0460	February 1, 1974	June 4, 1980	June 17, 2008
COLUMBUS, CITY OF	390170	0039', 0043, 0044, 0061', 0063', 0064, 0130, 0133, 0134, 0141, 0142, 0143, 0144, 0151, 0152, 0153, 0154', 0156, 0157, 0158, 0159, 0161, 0162, 0163, 0164, 0166, 0167, 0168', 0169, 0176, 0177, 0178', 0179', 0181, 0182, 0183, 0184, 0186', 0187, 0188', 0189, 0191, 0192, 0193, 0194, 0201, 0202, 0203, 0204, 0211, 0212, 0213, 0216, 0218, 0219', 0281, 0282', 0283, 0284, 0291, 0292, 0293, 0294, 0301, 0302, 0303, 0304, 0306, 0307, 0308, 0309, 0311, 0312, 0313, 0314, 0316, 0317, 0318, 0319, 0326', 0327, 0328, 0329, 0331, 0332, 0333, 0334, 0336, 0337', 0338, 0339, 0341, 0342, 0343, 0344, 0351, 0352, 0353, 0354, 0356, 0357', 0358, 0359, 0361, 0362, 0363, 0364, 0366, 0368, 0407, 0408, 0409, 0416', 0417, 0426, 0427, 0428, 0429, 0433, 0436, 0437, 0451, 0452, 0456	August 9, 1974	July 5, 1983	June 17, 2008
DUBLIN, CITY OF	390673	0016', 0017', 0018, 0019, 0038, 0039', 0127, 0130, 0131, 0132, 0133, 0134, 0151, 0152, 0153, 0154'	January 3, 1975	June 4, 1980	June 17, 2008
FRANKLIN COUNTY	390167	0039', 0043, 0044, 0063', 0064, 0069, 0090, 0095', 0120, 0127, 0130, 0131, 0132, 0133, 0134, 0137, 0140, 0141, 0142, 0143, 0144, 0151, 0152, 0153, 0154', 0156, 0157, 0158, 0159, 0161, 0162, 0163, 0164, 0166, 0168', 0169, 0176, 0177, 0178', 0179', 0181, 0182, 0183, 0184, 0186', 0187, 0189, 0191, 0193, 0194, 0201, 0202, 0203, 0204, 0206, 0207, 0208, 0209, 0211, 0212, 0213, 0214, 0216, 0217', 0218, 0219', 0257, 0267, 0270', 0276, 0277, 0278, 0279, 0281, 0282', 0283, 0284, 0290, 0291, 0292, 0293, 0294, 0301, 0302, 0303, 0304, 0306, 0307, 0308, 0309, 0311, 0312, 0313, 0314, 0316, 0317, 0318, 0319, 0326', 0327, 0328, 0329, 0331, 0332, 0333, 0334, 0336, 0337', 0338, 0339, 0341, 0342, 0343, 0344, 0351, 0352, 0353, 0354, 0356, 0357', 0358, 0359, 0361, 0362, 0363, 0364, 0366, 0368, 0407, 0408, 0409, 0416', 0417, 0426, 0427, 0428, 0429, 0433, 0436, 0437, 0451, 0452, 0456	April 7, 1978	July 5, 1983	June 17, 2008
GAHANNA, CITY OF	390171	0192, 0194, 0211, 0212, 0213, 0214, 0351, 0352	May 17, 1974	August 1, 1983	June 17, 2008
GRANDVIEW HEIGHTS, CITY OF	390172	0306, 0307	May 17, 1974	August 15, 1980	June 17, 2008
GROVE CITY, CITY OF	390173	0311, 0312, 0313, 0314, 0318, 0319, 0401, 0402, 0403, 0404, 0406, 0407, 0408, 0409	May 17, 1974	May 1, 1984	June 17, 2008
GROVEPORT, VILLAGE OF	390174	0343, 0344, 0363, 0431, 0432, 0433, 0434, 0451	May 31, 1974	September 1, 1983	June 17, 2008
HARRISBURG, VILLAGE OF	390897	0383, 0391	August 2, 1995	August 2, 1995	June 17, 2008
HILLIARD, CITY OF	390175	0133, 0134, 0137, 0141, 0142, 0143, 0144, 0153, 0161, 0163	June 7, 1974	August 1, 1979	June 17, 2008
LOCKBOURNE, VILLAGE OF	390691	0429, 0436, 0437	January 31, 1975	May 1, 1980	June 17, 2008
MARBLE CLIFF, VILLAGE OF	390896	0302, 0303	August 2, 1995	August 2, 1995	June 17, 2008
MINERVA PARK, VILLAGE OF	390791	0179', 0183	May 17, 1974	August 2, 1995	June 17, 2008
NEW ALBANY, VILLAGE OF	390895	0202, 0203, 0204, 0206, 0207, 0208, 0209, 0212, 0216, 0230'	August 2, 1995	August 2, 1995	June 17, 2008
OBETZ, VILLAGE OF	390176	0339, 0343, 0426, 0427, 0429, 0431	February 15, 1974	January 16, 1981	June 17, 2008
REYNOLDSBURG, CITY OF	390177	0352, 0354, 0356, 0357', 0358, 0359, 0362, 0366	November 23, 1973	September 1, 1978	June 17, 2008
RIVERLEA, VILLAGE OF	390692	0158, 0159	January 31, 1975	August 2, 1995	June 17, 2008
UPPER ARLINGTON, CITY OF	390178	0153, 0154', 0161, 0162, 0164, 0168, 0168', 0302, 0306	May 17, 1974	April 15, 1980	June 17, 2008
URBANCREST, VILLAGE OF	390893	0312, 0313, 0314	August 2, 1995	August 2, 1995	June 17, 2008
VALLEYVIEW, VILLAGE OF	390669	0304	July 11, 1975	June 15, 1978	June 17, 2008
WESTERVILLE, CITY OF	390179	0063', 0064, 0068', 0069, 0177, 0181, 0182, 0183, 0184	November 2, 1973	September 29, 1978	June 17, 2008
WHITEHALL, CITY OF	390180	0331, 0332, 0334, 0351, 0353	February 15, 1974	July 18, 1985	June 17, 2008
WORTHINGTON, CITY OF	390181	0156, 0157, 0158, 0159, 0176, 0178'	February 1, 1974	August 1, 1980	June 17, 2008

MAP DATES

This FIRM Index displays the map date for each FIRM panel at the time that this Index was printed. Because this Index may not be distributed to unaffected communities in subsequent revisions, users may determine the current map date for each FIRM panel by visiting the FEMA Map Service Center website at <http://msc.fema.gov> or by calling the Map Service Center at 1-800-358-9616.

Communities annexing land on adjacent FIRM panels must obtain a current copy of the adjacent panel as well as the current FIRM Index. These may be ordered directly from the Map Service Center at the number listed above.

BASE MAP SOURCE

Base Map information was obtained digitally from Franklin County Assessor Office and the Delaware County Auditor's Office.

NOTE TO USER

Future revisions to this FIRM Index will only be issued to communities that are located on FIRM panels being revised. This FIRM Index therefore remains valid for FIRM panels dated 06/17/2008 or earlier. Please refer to the "MOST RECENT FIRM PANEL DATE" column in the Listing of Communities table to determine the most recent FIRM index date for each community.

MAP REPOSITORIES

(Maps available for reference only, not for distribution.)

- | | | |
|--|--|--|
| BEXLEY, CITY OF:
Bexley City Hall
2242 East Main Street
Bexley, Ohio 43209 | GROVEPORT, VILLAGE OF:
Groveport Municipal Building
655 Blacklick Street
Groveport, Ohio 43125 | RIVERLEA, VILLAGE OF:
301 West Riverglen Drive
Worthington, Ohio 43085 |
| BRICE, VILLAGE OF:
Brice Village Municipal Building
5990 Columbus Street
Brice, Ohio 43109 | HARRISBURG, VILLAGE OF:
Harrisburg Village Hall
1100 High Street
Harrisburg, Ohio 43126 | UPPER ARLINGTON, CITY OF:
Upper Arlington City Hall
3600 Tremont Road
Upper Arlington, Ohio 43221 |
| CANAL WINCHESTER, VILLAGE OF:
Planning and Zoning
36 South High Street
Canal Winchester, Ohio 43110 | HILLIARD, CITY OF:
Hilliard City Hall
3800 Municipal Way
Hilliard, Ohio 43026 | URBANCREST, VILLAGE OF:
Urbancrest Village Hall
3492 First Avenue
Urbancrest, Ohio 43123 |
| COLUMBUS, CITY OF:
Department of Development
757 Carolyn Avenue
Columbus, Ohio 43224 | LOCKBOURNE, VILLAGE OF:
Lockbourne Municipal Building
85 Commerce Street
Lockbourne, Ohio 43137 | VALLEYVIEW, VILLAGE OF:
Valleyview Village Hall
2684 Elliot Avenue
Columbus, Ohio 43204 |
| DUBLIN, CITY OF:
Dublin Engineering Building
5800 Shier-Rings Road
Dublin, Ohio 43017 | MARBLE CLIFF, VILLAGE OF:
Marble Cliff Village Hall
1600 Fernwood Avenue
Columbus, Ohio 43212 | WESTERVILLE, CITY OF:
Westerville Planning and Development Department
64 East Walnut Street
Westerville, Ohio 43081 |
| FRANKLIN COUNTY:
Development Department
290 East Broad Street
Columbus, Ohio 43215 | MINERVA PARK, VILLAGE OF:
2829 Minerva Lake Road
Columbus, Ohio 43231 | WHITEHALL, CITY OF:
Whitehall City Hall
360 Yearling Road
Whitehall, Ohio 43213 |
| GAHANNA, CITY OF:
Gahanna City Hall
200 South Hamilton Road
Gahanna, Ohio 43230 | NEW ALBANY, VILLAGE OF:
New Albany Village Office
6145 Alum Creek Rd
New Albany, Ohio 43054 | WORTHINGTON, CITY OF:
City of Worthington Service & Engineering Office
374 Highland Avenue
Worthington, Ohio 43085 |
| GRANDVIEW HEIGHTS, CITY OF:
Development Office
1525 West Goodale Blvd
Grandview Heights, Ohio 43212 | OBETZ, VILLAGE OF:
Obetz Government Center
4175 Alum Creek Drive
Obetz, Ohio 43207 | |
| GROVE CITY, CITY OF:
Grove City City Hall
4035 Broadway Street
Grove City, Ohio 43123 | REYNOLDSBURG, CITY OF:
Reynoldsburg City Hall
7232 East Main Street
Reynoldsburg, Ohio 43068 | |

FRANKLIN COUNTY, OH INDEX LOCATOR DIAGRAM

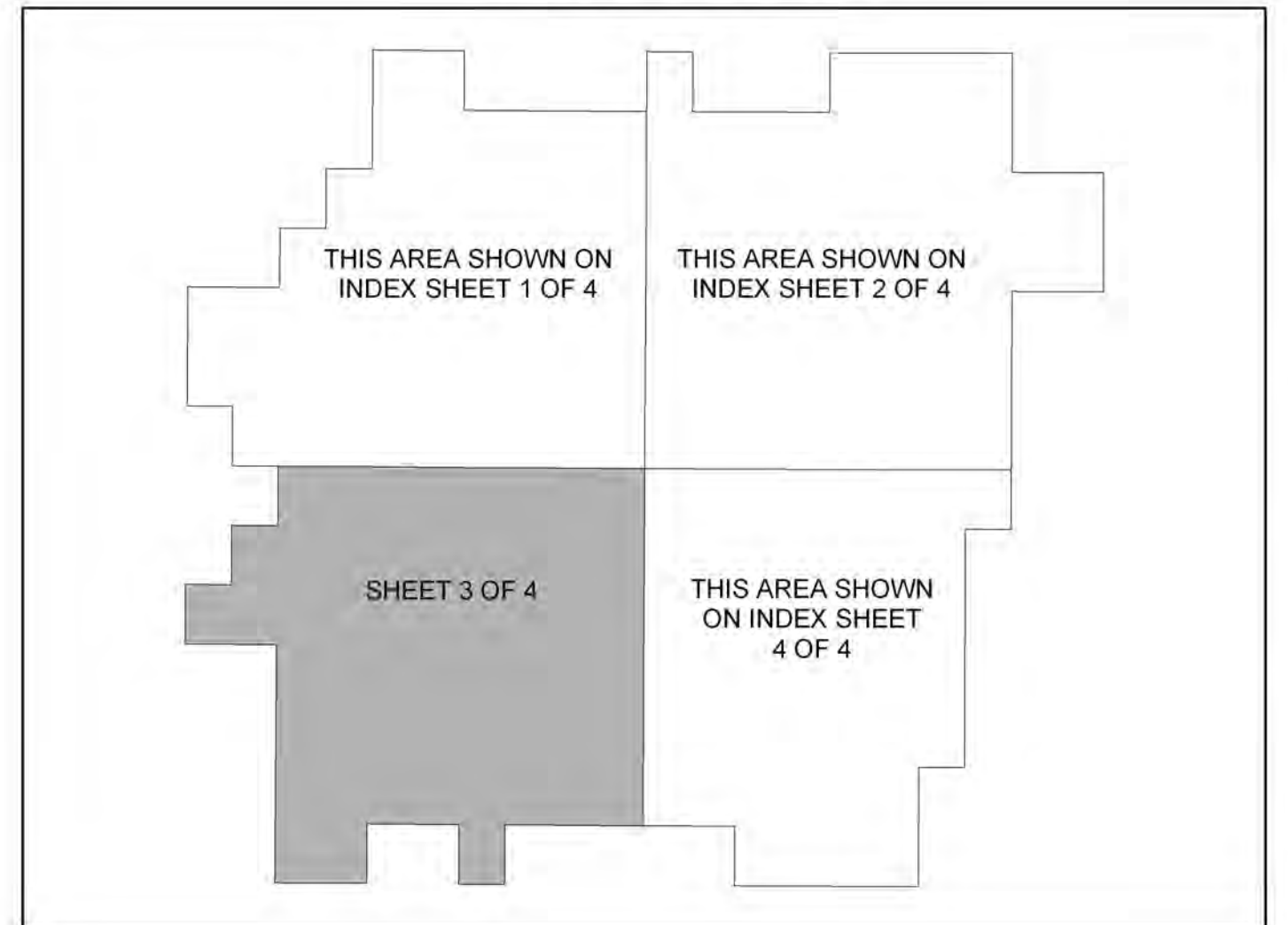

*PANEL NOT PRINTED - NO SPECIAL FLOOD HAZARD AREAS

ELEVATION DATUM

Flood elevations on this map are referenced to the North American Vertical Datum of 1988. These flood elevations must be compared to structure and ground elevations referenced to the same vertical datum. For information regarding conversion between the National Geodetic Vertical Datum of 1929 and the North American Vertical Datum of 1988, visit the National Geodetic Survey website at <http://www.ngs.noaa.gov/> or contact the National Geodetic Survey at the following address:

NGS Information Services
NOAA NGS12
National Geodetic Survey
SSMC-3, #5202
1315 East-West Highway
Silver Spring, Maryland 20910-3282
(301) 713-3242

MAP INDEX

FIRM
FLOOD INSURANCE RATE MAP
FRANKLIN COUNTY,
OHIO
AND INCORPORATED AREAS
(SEE LISTING OF COMMUNITIES TABLE)

MAP INDEX

SHEET 3 OF 4

PANELS PRINTED: 267, 278, 279, 283,
284, 290, 291, 292, 293, 294, 303, 304, 308, 309,
311, 312, 313, 314, 316, 317, 318, 319, 380, 383,
385, 391, 392, 401, 402, 403, 404, 406, 407, 408,
409, 417

(SEE SHEETS 1, 2, AND 4 FOR
ADDITIONAL PANELS PRINTED)

MAP NUMBER
39049CIND3C
MAP REVISED
JUNE 17, 2008

Federal Emergency Management Agency